

PREPARED FOR:
CALVIN L. STAKER
44 N. VAIL, #510
ARLINGTON HEIGHTS, IL
60005

PLAT OF SURVEY

-OF-

LOT 4 BLOCK "B" OF COUNTRY CLUB ESTATES UNIT 3,
LOCATED IN THE VILLAGE OF FONTANA-ON-GENEVA
LAKE, WALWORTH COUNTY, WISCONSIN.

KROTT SURVEYING INC.

N3705 WILLOW BEND LANE
LAKE GENEVA WI. 53147
PHONE # (262)248-3697
FAX # (262)249-0639

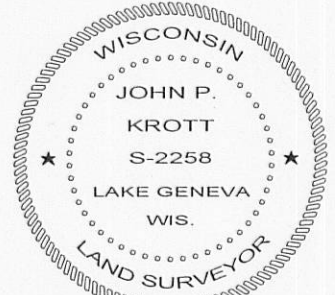
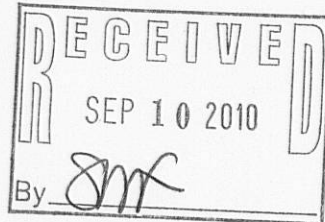
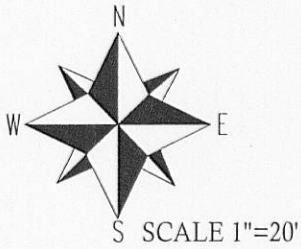

- LEGEND**
- FOUND IRON PIPE
 - FOUND IRON BAR
 - SET IRON BAR
 - (xx) RECORDED AS

JOB # 10-129 SCO300023

I have surveyed the above-described property and the above map is a true representation thereof and shows the size and location of the property, its exterior boundaries, the location and dimensions of all structures thereon, fences apparent easements and roadways and visible encroachments, if any.

This survey is made for the exclusive use of the present owners of the property, and also those who purchase, mortgage, or insure the title thereto within one (1) year from date hereof; and as to them I warrant the accuracy of said survey map.

DATED THIS 5th, DAY OF AUGUST, 2010

John P. Krott
JOHN KROTT S - 2258
Wisconsin Registered Land Surveyor
(original if signed in red)